

2971 – 2995 Mead Avenue

TERRENCE J. ROSE, INC.
REAL ESTATE

INVESTMENT & DEVELOPMENT

S A N T A C L A R A , C A L I F O R N I A



Warehouse Space for Lease

5,040 sq. ft.

\$1.25/sq.ft. IG

**2971-2995 Mead Ave.
Santa Clara, CA 95051**

- Easy access to freeway, expressways and public transportation
- Convenient to hotels, banks and restaurants
- Near Santa Clara Convention Center
- 200 – 400 Amps, 3 phase
- One Grade Level Door
- One Covered Dock High Door
- Air-Conditioned Office
- Space Heater in warehouse
- 15 feet clear height

For Information Contact:

Joan Jensen

Phone 408 496 1234 • Fax 408 988 4768 • www.tjrinc.com
3375 Scott Blvd., Suite 308, Santa Clara, California 95054

Mead Avenue

F L O O R P L A N S

Floor Plan

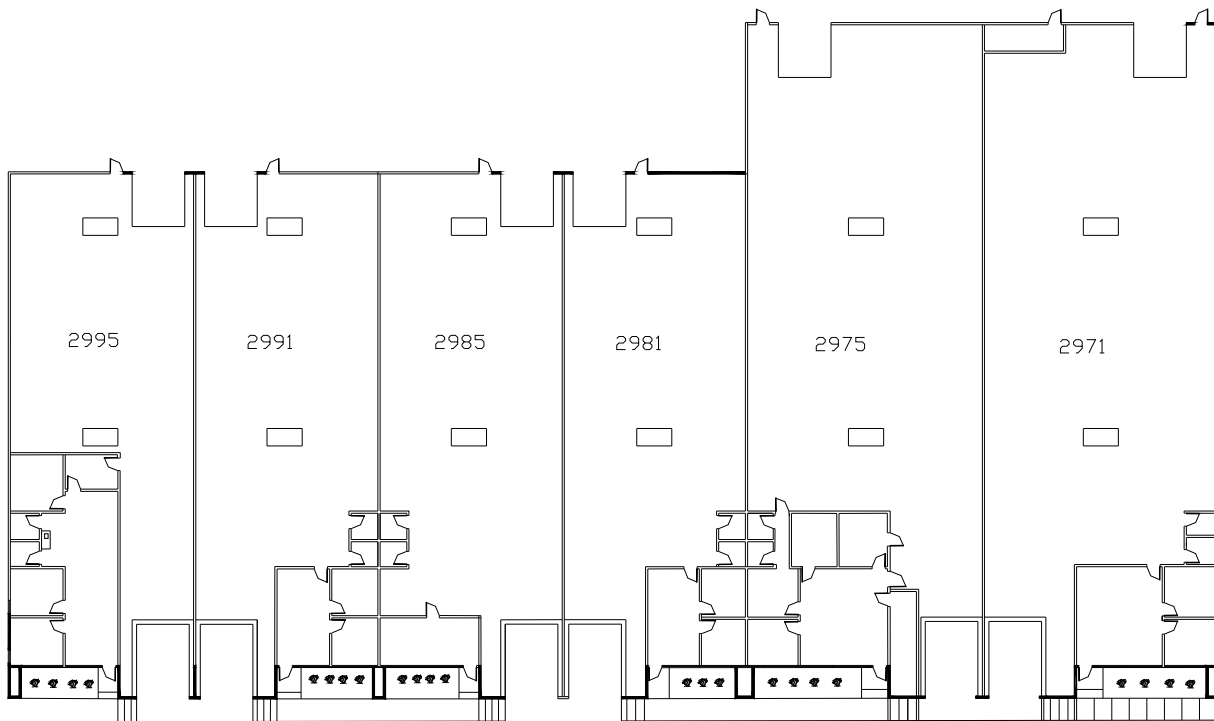

Map

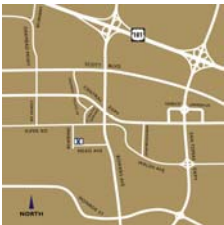

Available Space:

2985 Mead Ave – 5,040 sq. ft.

TERRENCE J. ROSE, INC.
REAL ESTATE

INVESTMENT & DEVELOPMENT

License No.
01187284

For Information Contact:

Joan Jensen

Phone 408 496 1234 • Fax 408 988 4768 • www.tjrinc.com
3375 Scott Blvd., Suite 308, Santa Clara, California 95054