

# For Lease

## 14,500 sq.ft. Industrial Bldg with LARGE YARD 1699 So. Tenth St., San Jose, CA



- ± 2,500 SF Office/Showroom
- Balance is Open Warehouse Space
- 4 Grade Level Doors
- **Fully Screened, Fenced and Gated**
- **Yard Area is 100% Concrete**
- **Enterprise Zone**
- **Zoned HI (Heavy Industrial)**
- This Property is Located on a Signalized Corner w/ Excellent Exposure to Phelan Avenue and 10th Street
- The Property formerly had an "Auto Dismantling" Permit
- **\$11,600 / mo NNN**
- **CALL TO TOUR**

### THOMAS LACKOVIC & ASSOCIATES

(408) 377-6711 Fax (408) 371-4445

Tom Lackovic  
(408) 377-6711  
Exclusive Agent

PRUNYARD TOWER ONE, SUITE 1000  
1901 SO. BASCOM AVENUE  
CAMPBELL, CA 95008  
Email: tom@lackovicandassociates.com  
DRE: 00482407

# 1699 So. Tenth St., San Jose, CA

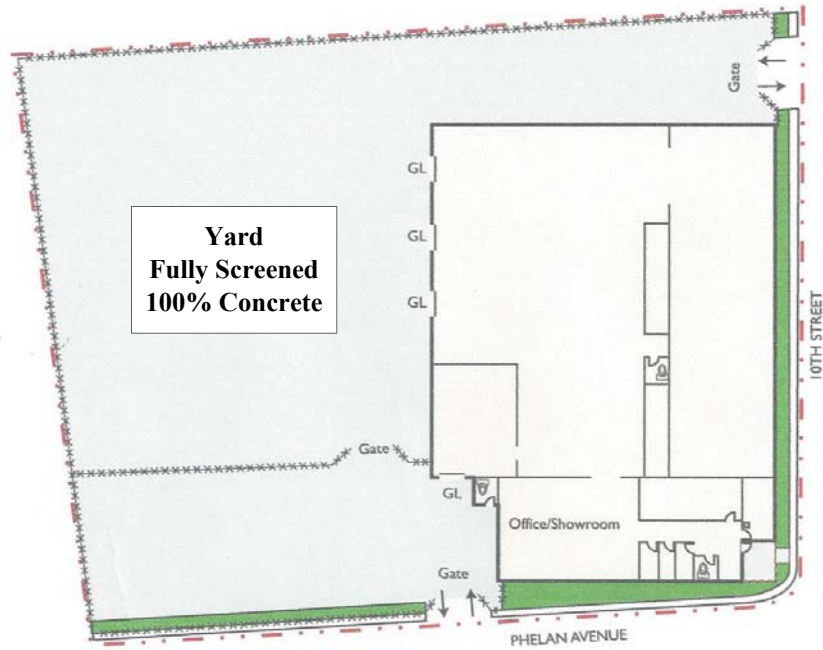

Drawing Not Exact, Not to Scale



REAR YARD

**THOMAS LACKOVIC & ASSOCIATES**

(408) 377-6711 Fax (408) 371-4445

Email: [tom@lackovicandassociates.com](mailto:tom@lackovicandassociates.com)  
DRE: 00482407

PRUNEYARD TOWER ONE, SUITE 1000  
1901 SO. BASCOM AVENUE  
CAMPBELL, CA 95008